

Dear Councillor

LICENSING SUB-COMMITTEE - WEDNESDAY, 29 APRIL 2026

I am now able to enclose for consideration at the above meeting the following reports that were unavailable when the agenda was printed.

**Agenda Item
No.**

- 5. DAVID LLOYD LEISURE, NUFFIELD ROAD, ST NEOTS PE19 0DR**
(Pages 3 - 32)
To consider an application to grant a new Premise Licence

Applicant: David Lloyd Leisure

Premises: Nuffield Road, St Neots PE19 0DR

Report attached

This page is intentionally left blank

LICENSING SUB-COMMITTEE

29th April 2026
LICENSING ACT 2003
APPLICATION TO GRANT A PREMISES LICENCE
David Lloyd Leisure Limited, Nuffield Road, St Neots, PE19 0DR
Application - 300273

1. INTRODUCTION

1.1 Huntingdonshire District Council as the Licensing Authority has received an application to Grant a Premise Licence:

from **David Lloyd Leisure Limited, The Hanger, Mosquito Way, Hatfield Business Park, Hatfield, Herts, AL10 9AX**

for the premises **David Lloyd Leisure, Nuffield Road, St Neots, PE19 0DR**

The Application was received on **19 March 2026**. As required under the Licensing Act 2003, notice of the application was advertised by blue notices displayed at or near the premises from **20 March 2026** and in the local newspaper on **25 March 2026**. The 28-day consultation period ended on **15 April 2026**.

1.2 A copy of the application is attached as **Appendix A** (application) & **Appendix B** (plan).

2. INFORMATION

2.1 The application is applying to permit the following licensable activities:

- a. **The showing of FILMS – Indoors**
 - i. Monday to Thursday 10:00 – 23:00
 - ii. Friday and Saturday 10:00 -01:00
 - iii. Sunday 10:00 – 23:00
- b. **Indoor Sporting Events**
 - i. Monday to Thursday 10:00 – 23:00
 - ii. Friday and Saturday 10:00 -01:00
 - iii. Sunday 10:00 – 23:00
- c. **Performance of LIVE MUSIC – Indoors**
 - i. Monday to Thursday 10:00 – 23:00
 - ii. Friday and Saturday 10:00 -01:00

- iii. Sunday 10:00 – 23:00
- d. **Performance of RECORDED MUSIC – indoors**
 - i. Monday to Thursday 10:00 – 23:00
 - ii. Friday and Saturday 10:00 -01:00
 - iii. Sunday 10:00 – 23:00
- e. **Performance of DANCE – Indoors**
 - i. Monday to Thursday 10:00 – 23:00
 - ii. Friday and Saturday 10:00 -01:00
 - iii. Sunday 10:00 – 23:00
- f. **Provision of LATE-NIGHT REFRESHMENT – Indoors**
 - i. Friday and Saturday 23:00 – 01:00
- g. **Supply of ALCOHOL – for consumption ON and OFF the premises**
 - i. Monday to Thursday 10:00 – 23:00
 - ii. Friday and Saturday 10:00 -01:00
 - iii. Sunday 10:00 – 23:00
- h. **Hours premise will be opening to the public**
 - i. Monday to Thursday 06:00 – 23:30
 - ii. Friday and Saturday 06:00 – 01:30
 - iii. Sunday 06:00 – 23:30
- i. **Seasonal Variations:**
 - i. To permit the sale of alcohol (and other licensable activities) on New Year’s Eve from 10:00, until the commencement of licensable activities at 10:00 on 1st January
 - ii. To permit sale of alcohol (and other licensable activities) to 01:00 the following mornings on Sundays preceding a Monday which is a bank or public holiday.

2.2 The application addresses the four licensing objectives. The proposed conditions have been recreated at **Appendix C** for ease. The proposals made in this section are normally translated directly into enforceable conditions that will be attached to the premises licence. Paragraphs 8.41- 8.49 and Section 10 of the Home Office guidance issued under section 182 refer to the operating schedule and licence conditions

3. REPRESENTATIONS

3.1 As part of the consultation the Responsible Authorities as determined under the Licensing Act 2003 were consulted on the application. No comments were received from Responsible Authorities.

3.2 During the period for representations 6 valid representations were received from 'other persons'. 5 have concerns about the application and 1 in support. The representations are **Appendix D1 and D2**.

3.3 A person who has submitted a relevant representation is entitled to address the Licensing Sub-Committee at the hearing and ask questions of any other party appearing at the hearing.

3.4 Not all matters raised within the representation may be relevant matters for consideration under the Licensing Act 2003.

4. MEDIATION

4.1 At the time of writing, no information regarding mediation has been provided by the applicant, or their legal advisors. Any further information will be circulated prior to or at the hearing.

5. GENERAL DUTY/POLICY CONSIDERATION

5.1 The licensing authority must carry out its functions under the Act with a view to promoting the licensing objectives, each objective has equal importance, the objectives are:

- a. the prevention of crime and disorder,
- b. public safety,
- c. the prevention of public nuisance, and
- d. the protection of children from harm.

5.2 The sub-committee must also have regard to:

- a. its statement of licensing policy, and
- b. any statutory guidance issued under Section 182 of the Licensing Act 2003. As amended February 2026, including but not limited to
 - i. Conditions attached to premises licences 10.1 – 10.10
 - ii. Planning and Building Control 14.65 – 14.67
 - iii. Overview of circumstances in which entertainment activities are not licensable 16.5 to 16.9
- c. the Human Rights Act 1988
- d. Live Music Act 2012

5.3 The Council must also fulfil its obligations under Section 17 of the Crime and Disorder Act 1998 to do all that it reasonably can to prevent crime and disorder in its district.

6. DETERMINATION

6.1 In making a decision, this application must be determined on its individual merits having regard to the representations and supporting documents included as part of the report along with additional information considered relevant at the hearing.

As part of the decision process the sub-committee is required to give its reasons for any decision arrived at.

6.2 Where the licensing authority considers that action under its statutory powers is appropriate, it may take any of the following steps:

- Grant the application as applied for
- Refuse the application
- Add additional conditions to the premises licence
- Exclude any licensable activities applied for
- Amend dates and times of licensable activities applied for.

6.3 Any decision made by the sub-committee must be reasonable and proportionate and promote the Licensing objectives.

BACKGROUND INFORMATION

Licensing Act 2003.

Guidance issued under section 182 of the Licensing Act 2003. As amended February 2026

The Council's Statement of Licensing Policy.

LIST OF APPENDICES



Appendix A – Application to Grant a Premises Licence

Appendix B 1-3 – Licensing Plans

Appendix C – Schedule of proposed conditions

Appendix D 1 & 2 – Representation from 'Other Persons'

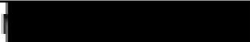
Online Application Details

General Details				
Licence Type		Premises Licence		
Application Type		Premises licence - new		
Fees	Type	Detail	Fee Multiplier	Total
	Rateable Value	Band C £33,001 to £87,000	x1	£315.00
	Capacity	0 to 4,999	x1	£0.00
Total Fee(s)		£315.00		
Location to be Licenced		David Lloyd Club Nuffield Road St Neots Cambridgeshire PE19 0DR		
Trading Name		David Lloyd		
I am the		Agent		
Agent Details		 John Gaunt and Partners 372 Cemetery Road Sheffield South Yorkshire S11 8FT 		
Proposed Licence Holder Details		David Lloyd Leisure Limited The Hangar Mosquito Way Hatfield Business Park Hatfield Hertfordshire AL10 9AX 		
Additional Proposed Licence Holder(s)				
Additional Contacts				
Licence Type Additional Data Setting				
Please confirm that you have read the notes above on demonstrating entitlement to work in the UK		Yes		
Proposed licence holder right to work share code				
Proposed licence holder nationality		n/a - company		
Additional proposed licence holder right to work share code				

Additional proposed licence holder nationality	
Telephone number	
In what capacity are you applying for the premises licence?	**A limited company / limited liability partnership**
Confirm one of the following	I am carrying on or proposing to carry on a business which involves the use of the premises for licensable activities
When do you want the premises licence to start?	16-04-2026
If you wish the licence to be valid only for a limited period, when do you want it to end?	
Please confirm you have read the notes above on regulated entertainment	Yes
Please confirm whether you are planning to supply alcohol	Yes
Date of Birth	██████████
Please confirm you have read and understood the above declaration	Yes
Full name	John Gaunt & Partners
Capacity	Solicitors for the applicant
Premise Alcohol Licence	
Premises description	<p>It is intended that the premises will operate as a David Lloyd Leisure Centre providing leisure facilities with the usual food and beverage provision and occasional regulated entertainment facilities. The details of the development are shown on the drawings identified below as deposited with this application. It is proposed that the permitted hours for licensable activities at these premises should normally be no later than 10.00 – 23.00 with the premises closing to the general public 30 minutes thereafter, other than identified non-standard timings relating to bank holiday Sundays and New Year's Eve. However, within the application a terminal hour for licensable activities is given on Fridays and Saturdays as 01.00 the following mornings. This is to allow for occasional flexibility for functions and similar events to be held within the premises on those days, the number of which terminating at 01.00 for licensable activities should be limited to 18 in any calendar year. The application seeks to license the premises under the Licensing Act 2003 for the following activities:</p> <p>1. Occasional regulated entertainment comprising films, indoor sporting events, live music, recorded music, performance of dance as further particularised in the boxes below. 2. The sale of alcohol by retail. 3. The provision of late night refreshment after 23:00. The drawings deposited with this application are: •drawing A-09-002 Revision P01– site location licensing plan; •drawing LP-04-001 Revision P01 – ground floor licensing plan; and •drawing LP-04-002 Revision P01 – indicative first floor plan. Please note the internal areas edged red on the deposited drawings are intended to be used for all licensable activities. Internal and external</p>

	areas hatched red will be licensed for the sale of alcohol. In addition, there will be on site car parking facilities as identified on the deposited site location licensing plan. It is not anticipated that this application, taken with the Operating Schedule, will adversely impact upon the licensing objectives.
Will you be providing plays?	No
Plays Standard Start Monday	
Plays Standard End Monday	
Plays Standard Start Tuesday	
Plays Standard End Tuesday	
Plays Standard Start Wednesday	
Plays Standard End Wednesday	
Plays Standard Start Thursday	
Plays Standard End Thursday	
Plays Standard Start Friday	
Plays Standard End Friday	
Plays Standard Start Saturday	
Plays Standard End Saturday	
Plays Standard Start Sunday	
Plays Standard End Sunday	
Plays Licence Location	
Plays Further Details	
Plays Seasonal Variations	
Plays Non Standard Times	
Will you be providing films?	Yes
Films Standard Start Monday	10:00
Films Standard End Monday	23:00
Films Standard Start Tuesday	10:00
Films Standard End Tuesday	23:00
Films Standard Start Wednesday	10:00
Films Standard End Wednesday	23:00
Films Standard Start Thursday	10:00
Films Standard End Thursday	23:00
Films Standard Start Friday	10:00
Films Standard End Friday	01:00
Films Standard Start Saturday	10:00
Films Standard End Saturday	01:00
Films Standard Start Sunday	10:00
Films Standard End Sunday	23:00
Films Licence Location	Indoors
Films Further Details	Exhibition of a film principally (but not exclusively) video entertainment on screens and TV screens.

Films Seasonal Variations	N/A – save as below
Films Non Standard Times	When hours for sale of alcohol are extended hereunder these hours are also extended
Will you be providing indoor sporting events?	Yes
Indoor Sporting Events Standard Start Monday	10:00
Indoor Sporting Events Standard End Monday	23:00
Indoor Sporting Events Standard Start Tuesday	10:00
Indoor Sporting Events Standard End Tuesday	23:00
Indoor Sporting Events Standard Start Wednesday	10:00
Indoor Sporting Events Standard End Wednesday	23:00
Indoor Sporting Events Standard Start Thursday	10:00
Indoor Sporting Events Standard End Thursday	23:00
Indoor Sporting Events Standard Start Friday	10:00
Indoor Sporting Events Standard End Friday	01:00
Indoor Sporting Events Standard Start Saturday	10:00
Indoor Sporting Events Standard End Saturday	01:00
Indoor Sporting Events Standard Start Sunday	10:00
Indoor Sporting Events Standard End Sunday	23:00
Indoor Sporting Events Further Details	Indoor sports in the presence of an audience.
Indoor Sporting Events Seasonal Variations	N/A – save as below
Indoor Sporting Events Non Standard Times	When hours for sale of alcohol are extended hereunder these hours are also extended
Will you be providing boxing or wrestling entertainment?	No
Boxing Or Wrestling Entertainment Standard Start Monday	
Boxing Or Wrestling Entertainment Standard End Monday	
Boxing Or Wrestling Entertainment Standard Start Tuesday	
Boxing Or Wrestling Entertainment Standard End Tuesday	
Boxing Or Wrestling Entertainment Standard Start Wednesday	
Boxing Or Wrestling Entertainment Standard End Wednesday	
Boxing Or Wrestling Entertainment Standard Start Thursday	
Boxing Or Wrestling Entertainment Standard End Thursday	
Boxing Or Wrestling Entertainment Standard Start Friday	
Boxing Or Wrestling Entertainment Standard End Friday	
Boxing Or Wrestling Entertainment Standard Start Saturday	
Boxing Or Wrestling Entertainment Standard End Saturday	

Boxing Or Wrestling Entertainment Standard Start Sunday	
Boxing Or Wrestling Entertainment Standard End Sunday	
Boxing Or Wrestling Entertainment Licence Location	
Boxing Or Wrestling Entertainment Further Details	
Boxing Or Wrestling Entertainment Seasonal Variations	
Boxing Or Wrestling Entertainment Non Standard Times	
Will you be providing live music?	Yes
Live Music Standard Start Monday	10:00
Live Music Standard End Monday	23:00
Live Music Standard Start Tuesday	10:00
Live Music Standard End Tuesday	23:00
Live Music Standard Start Wednesday	10:00
Live Music Standard End Wednesday	23:00
Live Music Standard Start Thursday	10:00
Live Music Standard End Thursday	23:00
Live Music Standard Start Friday	10:00
Live Music Standard End Friday	01:00
Live Music Standard Start Saturday	10:00
Live Music Standard End Saturday	01:00
Live Music Standard Start Sunday	10:00
Live Music Standard End Sunday	23:00
Live Music Licence Location	Indoors
Live Music Further Details	Occasional live music and amplified voice
Live Music Seasonal Variations	N/A – save as below
Live Music Non Standard Times	When hours for sale of alcohol are extended hereunder these hours are also extended
Will you be providing recorded music?	Yes
Recorded Music Standard Start Monday	10:00
Recorded Music Standard End Monday	23:00
Recorded Music Standard Start Tuesday	10:00
Recorded Music Standard End Tuesday	23:00
Recorded Music Standard Start Wednesday	10:00
Recorded Music Standard End Wednesday	23:00
Recorded Music Standard Start Thursday	10:00
Recorded Music Standard End Thursday	23:00
Recorded Music Standard Start Friday	10:00
Recorded Music Standard End Friday	01:00
Recorded Music Standard Start Saturday	10:00
Recorded Music Standard End Saturday	01:00
Recorded Music Standard Start Sunday	10:00

Recorded Music Standard End Sunday	23:00
Recorded Music Licence Location	Indoors
Recorded Music Further Details	Occasional recorded music, including juke box, with or without a DJ, during normal business hours or as part of functions and including audience participation
Recorded Music Seasonal Variations	N/A – save as below
Recorded Music Non Standard Times	When hours for sale of alcohol are extended hereunder these hours are also extended
Will you be providing performance of dance?	Yes
Performance Of Dance Standard Start Monday	10:00
Performance Of Dance Standard End Monday	23:00
Performance Of Dance Standard Start Tuesday	10:00
Performance Of Dance Standard End Tuesday	23:00
Performance Of Dance Standard Start Wednesday	10:00
Performance Of Dance Standard End Wednesday	23:00
Performance Of Dance Standard Start Thursday	10:00
Performance Of Dance Standard End Thursday	23:00
Performance Of Dance Standard Start Friday	10:00
Performance Of Dance Standard End Friday	01:00
Performance Of Dance Standard Start Saturday	10:00
Performance Of Dance Standard End Saturday	01:00
Performance Of Dance Standard Start Sunday	10:00
Performance Of Dance Standard End Sunday	23:00
Performance Of Dance Licence Location	Indoors
Performance Of Dance Further Details	Performances of dance or other similar activity
Performance Of Dance Seasonal Variations	N/A – save as below
Performance Of Dance Non Standard Times	When hours for sale of alcohol are extended hereunder these hours are also extended
Will you be providing anything similar to live music, recorded music or performances of dance?	No
Other Standard Activities Standard Start Monday	
Other Standard Activities Standard End Monday	
Other Standard Activities Standard Start Tuesday	
Other Standard Activities Standard End Tuesday	
Other Standard Activities Standard Start Wednesday	
Other Standard Activities Standard End Wednesday	
Other Standard Activities Standard Start Thursday	
Other Standard Activities Standard End Thursday	
Other Standard Activities Standard Start Friday	
Other Standard Activities Standard End Friday	
Other Standard Activities Standard Start Saturday	
Other Standard Activities Standard End Saturday	

Other Standard Activities Standard Start Sunday	
Other Standard Activities Standard End Sunday	
Other Standard Activities Description	
Other Standard Activities Licence Location	
Other Standard Activities Further Details	
Other Standard Activities Seasonal Variations	
Other Standard Activities Non Standard Times	
Will you be providing late night refreshment?	Yes
Late Night Standard Start Monday	
Late Night Standard End Monday	
Late Night Standard Start Tuesday	
Late Night Standard End Tuesday	
Late Night Standard Start Wednesday	
Late Night Standard End Wednesday	
Late Night Standard Start Thursday	
Late Night Standard End Thursday	
Late Night Standard Start Friday	23:00
Late Night Standard End Friday	01:00
Late Night Standard Start Saturday	23:00
Late Night Standard End Saturday	01:00
Late Night Standard Start Sunday	
Late Night Standard End Sunday	
Late Night Licence Location	Indoors
Late Night Further Details	To allow the provision of hot food and drinks
Late Night Seasonal Variations	N/A – save as below
Late Night Non Standard Times	1. To permit late night refreshment on New Year's Eve from 23:00 until 05:00 the following morning. 2.To permit late night refreshment from 23:00 to 01:00 the following mornings on Sundays preceding a Monday which is a bank or public holiday.
Will you be selling or supplying alcohol?	Yes
Supply Of Alcohol Standard Start Monday	10:00
Supply Of Alcohol Standard End Monday	23:00
Supply Of Alcohol Standard Start Tuesday	10:00
Supply Of Alcohol Standard End Tuesday	23:00
Supply Of Alcohol Standard Start Wednesday	10:00
Supply Of Alcohol Standard End Wednesday	23:00
Supply Of Alcohol Standard Start Thursday	10:00
Supply Of Alcohol Standard End Thursday	23:00
Supply Of Alcohol Standard Start Friday	10:00
Supply Of Alcohol Standard End Friday	01:00
Supply Of Alcohol Standard Start Saturday	10:00
Supply Of Alcohol Standard End Saturday	01:00

Supply Of Alcohol Standard Start Sunday	10:00
Supply Of Alcohol Standard End Sunday	23:00
Supply Of Alcohol Licence Location	For consumption on and off the premises
Supply Of Alcohol Seasonal Variations	N/A – save as below
Supply Of Alcohol Non Standard Times	1. To permit the sale of alcohol (and other licensable activities) on New Year's Eve from 10:00 until the commencement of licensable activities at 10:00 on 1st January. 2. To permit sale of alcohol (and other licensable activities) to 01:00 the following mornings on Sundays preceding a Monday which is a bank or public holiday.
Concerns In Respect Of Children	None
Opening Hours Standard Start Monday	06:00
Opening Hours Standard End Monday	23:30
Opening Hours Standard Start Tuesday	06:00
Opening Hours Standard End Tuesday	23:30
Opening Hours Standard Start Wednesday	06:00
Opening Hours Standard End Wednesday	23:30
Opening Hours Standard Start Thursday	06:00
Opening Hours Standard End Thursday	23:30
Opening Hours Standard Start Friday	06:00
Opening Hours Standard End Friday	01:30
Opening Hours Standard Start Saturday	06:00
Opening Hours Standard End Saturday	01:30
Opening Hours Standard Start Sunday	06:00
Opening Hours Standard End Sunday	23:30
Opening Hours Seasonal Variations	See sale of alcohol seasonal variations
Opening Hours Non Standard Times	The premises will close 30 minutes after the end of the non-standard timings identified for the sale of alcohol
a) General - all four licensing objectives (b,c,d,e)	I have undertaken my own risk assessment to take the following proposed steps.
b) The prevention of crime and disorder	No further risks have been identified which need to be addressed, save as follows 1.tThe use of door staff will be risk assessed on an ongoing basis by the licence holder or premises supervisor. Where engaged, door staff shall be licensed by the Security Industry Authority. 2.tAlcoholic and other drinks may not be removed from the building in open containers except for consumption in any external area provided for that purpose. 3.tStaff will receive training on matters concerning underage sales, drugs policies, and operating procedures. 4.tThere shall be a zero tolerance policy in relation to drugs at the premises and there shall be regular checks by management to prevent the use of drugs by patrons. Drugs seized shall be stored securely and handed to the police. 5.tThe premises will operate a proof of age scheme and will require photographic identification from any person who appears to be under the age of 21

	years. 6. CCTV shall be installed with recording facilities such recordings shall be retained for a period of 28 days (except where such retention cannot be achieved due to reasonable periods of maintenance or repair) and made available within a reasonable time upon request by the police as long as the request is in accordance with data protection principles.
c) Public safety	No further risks have been identified which need to be addressed, save as follows 7. To comply with the reasonable requirements of the fire officer from time to time. 8. The premises will have adequate safety and firefighting equipment and such equipment will be maintained in good operational order.
d) The protection of public nuisance	No further risks have been identified which need to be addressed, save as follows 12. Noise shall not emanate from the premises so as to cause a nuisance to nearby noise sensitive properties.
e) The protection of children from harm	The restrictions set out in the Licensing Act 2003 will apply. No unusual or additional risks of harm to children have been identified. 13. No films or videos of any description will be shown so that they can be viewed by persons under the age of any applicable BBFC/Local Authority certification. 14. There shall be adequate controls in place including staff training to safeguard against the sale of alcohol to persons under 18 years. 15. The premises supervisor or appointed staff member shall ensure that when children are admitted to the premises their presence is not inconsistent with the style of operation of the premises at that time and the licensable activities that are being carried out.
Personal Alcohol Licence Holder	
Personal Alcohol Licence	
Contact	
Full Name	Matthew Borer
Address	
Personal Licence Number	11/01124/LIPERS
Issuing licensing authority (if known)	Croydon
Please confirm that these details are for the proposed designated premises supervisor	Yes
Start Date	
End Date	
Licence Activity	
Licence Activity Type	
Area	
Licence Location	
Standard Start Monday	
Standard End Monday	

Standard Start Tuesday	
Standard End Tuesday	
Standard Start Wednesday	
Standard End Wednesday	
Standard Start Thursday	
Standard End Thursday	
Standard Start Friday	
Standard End Friday	
Standard Start Saturday	
Standard End Saturday	
Standard Start Sunday	
Standard End Sunday	
Further Details	
Seasonal Variations	
Non Standard Time	

Customer Comments:

DO NOT SCALE FROM THIS DRAWING. USE FIGURED DIMENSIONS ONLY UNLESS EXPLICITLY AGREED. VERIFY ALL DIMENSIONS AND SETTING OUT ON SITE. NOTIFY ANY DISCREPANCIES TO THE ARCHITECT. FOR STRUCTURAL INFORMATION, REFER TO STRUCTURAL ENGINEER'S DRAWINGS. FOR M&E INFORMATION, REFER TO M&E ENGINEER'S AND SUB-CONTRACTORS' DRAWINGS. FOR HEALTH & SAFETY INFORMATION, REFER TO HEALTH & SAFETY RISK ASSESSMENTS.



0m 10 20 30 40 50
1:500

- All licensable activities
- Sale of alcohol
- Proposed site

Page 17

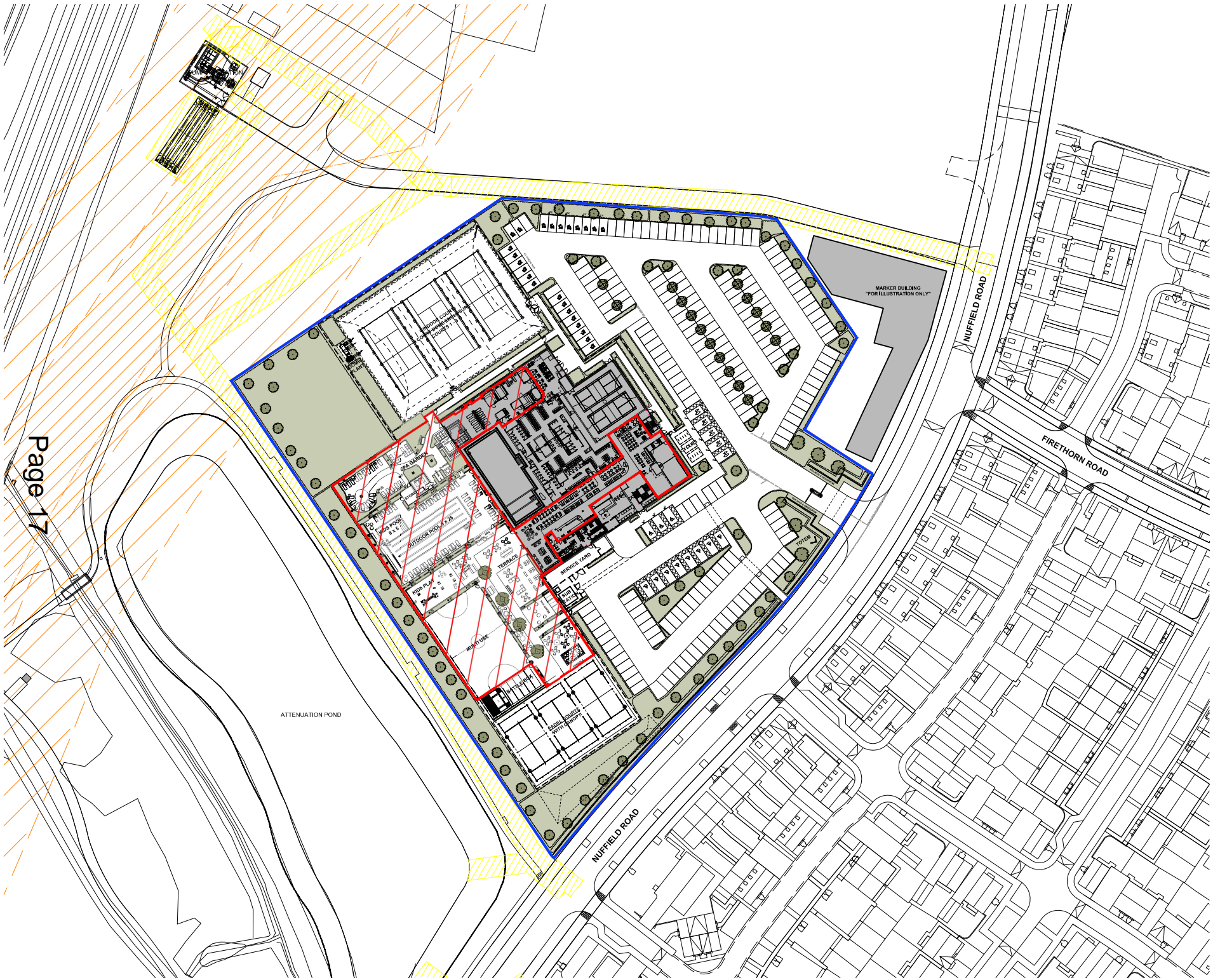

DATE: P01 11-AG 00000 SEDF 000 000020200
 FIRST ISSUE
S3 | FOR REVIEW & COMMENT



**ST NEOTS
WINTRINGHAM PARK**

**PROPOSED
SITE LICENSING PLAN**

Hadfield Cawkwell Davidson
 Broomgrove Lodge, 13 Broomgrove Rd, Sheffield, S10 2JZ T 0114 266 8181 www.hcd.co.uk

PROJECT NO 2023-249	DATE 1:500 @ A1	SCALE P01
PROJECT NO 23249	DATE HCD ZZ 00 DR	SCALE A-09-002

© Architectural 2023-249/2023-249-001-Hadfield Cawkwell Davidson - Proposed Site Licensing Plan.dwg | 1/01

Any information contained on the plan which is not prescribed under the Licensing Act 2003 (Premises licences and club premises certificates) Regulations 2005 should be taken as being illustrative only

This page is intentionally left blank

This page is intentionally left blank

This page is intentionally left blank

Application 300273 – David Lloyd Leisure Limited

Steps to be taken to promote the four licensing objectives

General

I have undertaken my own risk assessment to take the following proposed steps.

Prevention of crime and disorder

No further risks have been identified which need to be addressed, save as follows

- 1.The use of door staff will be risk assessed on an ongoing basis by the licence holder or premises supervisor. Where engaged, door staff shall be licensed by the Security Industry Authority.
- 2.Alcoholic and other drinks may not be removed from the building in open containers except for consumption in any external area provided for that purpose.
- 3.Staff will receive training on matters concerning underage sales, drugs policies, and operating procedures.
- 4.There shall be a zero tolerance policy in relation to drugs at the premises and there shall be regular checks by management to prevent the use of drugs by patrons. Drugs seized shall be stored securely and handed to the police.
- 5.The premises will operate a proof of age scheme and will require photographic identification from any person who appears to be under the age of 21 years.
- 6.CCTV shall be installed with recording facilities such recordings shall be retained for a period of 28 days (except where such retention cannot be achieved due to reasonable periods of maintenance or repair) and made available within a reasonable time upon request by the police as long as the request is in accordance with data protection principles.

Public Safety

No further risks have been identified which need to be addressed, save as follows

- 7.To comply with the reasonable requirements of the fire officer from time to time.
- 8.The premises will have adequate safety and firefighting equipment and such equipment will be maintained in good operational order.

Prevention of Public Nuisance

No further risks have been identified which need to be addressed, save as follows

9. Noise shall not emanate from the premises so as to cause a nuisance to nearby noise sensitive properties.

Protection of children from Harm

The restrictions set out in the Licensing Act 2003 will apply.

No unusual or additional risks of harm to children have been identified.

10. No films or videos of any description will be shown so that they can be viewed by persons under the age of any applicable BBFC/Local Authority certification.

11. There shall be adequate controls in place including staff training to safeguard against the sale of alcohol to persons under 18 years.

12. The premises supervisor or appointed staff member shall ensure that when children are admitted to the premises their presence is not inconsistent with the style of operation of the premises at that time and the licensable activities that are being carried out.

Representations Objecting

Name and contact	Date Received	Comments
<p>[REDACTED]</p>	<p>20.03.2026</p>	<p>Object to the following assessment "Opening Hours Public Nuisance Description: No further risks have been identified which need to be addressed, save as follows 12. Noise shall not emanate from the premises so as to cause a nuisance to nearby noise sensitive properties".</p> <p>Nuffield Road is directly opposite the premises and are already facing noise nuisance from the current construction which is limited to Mon to Sat 8am to 6pm.</p> <p>The proposed times are guaranteed to cause further noise disturbance throughout the night until 1am. A late night premises that provides live music, entertainment and alcohol is not what residents accepted in the initial application.</p> <p>An earlier closing time would like to be considered.</p>
<p>[REDACTED]</p>	<p>22.03.2026</p>	<p>Dear Licensing Authority, Re: Premises Licence Variation – Licence ID 300273</p> <p>I am writing to make a formal representation objecting to the proposed variation of the premises licence. I am a resident of Nuffield Road ([REDACTED]), and my home is located [REDACTED] the premises.</p> <p>My objection is based on the licensing objectives of the prevention of public nuisance and the protection of children from harm.</p>

	<p>Due to my property being directly opposite the entrance, I am in extremely close proximity to the primary point of arrival and dispersal for patrons. This places my household at particular risk of disturbance from:</p> <ul style="list-style-type: none">* People arriving and leaving the premises late at night* Raised voices, conversations, and general activity outside the entrance* Vehicles, doors slamming, and engine noise* Any queuing or congregation associated with events <p>In addition, [REDACTED] located at the front of the property and [REDACTED] the premises. As such, [REDACTED] is especially vulnerable to disturbance from both noise and light late into the evening.</p> <p>The proposal to extend operating hours until 23:30 daily, combined with live music and events, is likely to significantly increase noise levels. Amplified music, particularly bass frequencies, is well known to travel and penetrate residential properties, even when windows are closed. Given the direct facing relationship and very close proximity, even moderate increases in activity are likely to result in regular sleep disturbance.</p> <p>This is a residential area, and the proposed intensification of use is not compatible with the reasonable expectation of a quiet living environment, particularly for families with young children.</p> <p>The cumulative impact of late-night use on a daily basis is also a significant concern, as it would result in ongoing disturbance rather than occasional events.</p> <p>Should the Licensing Authority be minded to grant the application, I strongly request that conditions are imposed, including:</p> <ul style="list-style-type: none">* Earlier closing times appropriate for a residential setting* No outdoor use or congregation late at night* Strict limits on live and amplified music
--	---

		<ul style="list-style-type: none"> * A detailed and enforceable noise management plan * Measures to control dispersal noise at the entrance (staff supervision, signage) * Controls on external lighting to prevent light intrusion into nearby homes <p>Without such conditions, I believe the application would lead to a clear and ongoing public nuisance. I respectfully request that this representation is taken fully into account in the determination of the application.</p>
	<p>28.03.2026</p>	<p>Dear Sir or Madam, Re: Premises Licence Variation – Licence ID 300273</p> <p>I write to make a formal representation in respect of the above application. I am a resident of Nuffield Road (), and my property is () to the premises. Owing to this very close proximity, my household would be particularly affected by any increase in activity associated with the use of the premises.</p> <p>This representation is made on the basis of the licensing objective of the prevention of public nuisance.</p> <p>The position of my home places us () to the principal point of arrival and dispersal for patrons. In practical terms, this is likely to result in disturbance arising from people arriving and leaving the premises during the evening, raised voices and general congregation outside the entrance, as well as noise from vehicles, including engines idling and doors closing.</p> <p>Of particular concern is that our () (), directly facing the premises. As such, we would be especially susceptible to disturbance from both noise and light intrusion during the later hours. The proposed extension of hours to 23:30 daily is, in itself, a significant concern.</p> <p>However, the proposal to permit operation until 01:00 on Fridays and Saturdays for up to 18 weeks of the year represents a substantial intensification of late-night use. Activity at this time is far more likely to give rise to elevated noise levels,</p>

	<p>particularly associated with patrons leaving the premises, and is incompatible with the reasonable expectation of rest during night-time hours.</p> <p>Furthermore, the proposed sale and consumption of alcohol late into the night, especially in any external areas, gives rise to additional concern. Experience shows that alcohol-related activity is more likely to result in raised voices, prolonged congregation, and difficulty in controlling dispersal. The use of external areas at such hours would significantly increase the likelihood of noise breakout directly affecting neighbouring residential properties.</p> <p>It is well recognised that amplified music, and in particular low-frequency bass, can travel beyond the premises and into neighbouring residential properties, even where windows are closed. Given the proximity involved, it is difficult to see how regular disturbance could be avoided.</p> <p>Nuffield Road is a residential area, and residents are entitled to a reasonable degree of peace and quiet, particularly during the evening and night-time. The cumulative effect of extended hours, late-night alcohol use, and external activity is likely to result in ongoing disturbance. This would have a direct and detrimental impact on my ability to sleep.</p> <p>██████████ adequate rest is essential, and regular disturbance during late hours would have a clear effect on my wellbeing and ability to carry out my professional responsibilities.</p> <p>In the event that the Licensing Authority is minded to grant the application, I would respectfully request that appropriate and proportionate conditions are imposed, including:</p> <ul style="list-style-type: none">• earlier closing hours suitable for a residential setting, with no operation beyond 22:00 on weekdays and 23:00 on weekends.• no use of external areas during the evening and night-time hours;
--	---

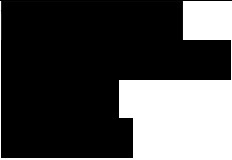
		<ul style="list-style-type: none"> •no sale or consumption of alcohol in external areas; •strict controls on live and amplified music; •a robust and enforceable noise management plan; •effective management of dispersal, including staff supervision; and •measures to prevent light spill affecting neighbouring properties. <p>However, as presently proposed, the application does not satisfactorily demonstrate how the licensing objective will be promoted, nor how the impact on neighbouring residents will be adequately mitigated. In those circumstances, I respectfully submit that the application should be refused.</p>
	29.03.2026	This is too late at night being in a residential area. This is a family area with a school and should be treated as such, without disruption until 1am in the morning on Friday and Saturdays. Generally there is noise limits until 10pm at night
	14.04.2026	<p>This representation relates chiefly to the third licensing objective - The Prevention of Public Nuisance. However, there are concerns under all four licensing objections relating to this application.</p> <p><u>We live directly across the road from the opening to</u> the car park of the David Lloyd Leisure Site and we have concerns about it essentially operating as a late night entertainment venue.</p> <p>We initially supported the application of the site to become a David Lloyd Leisure Centre, however this was on the understanding that it would simply be a leisure centre. Allowing visitors to exercise, work out, and use other facilities between reasonable opening hours.</p>

		<p>These extended hours are seeking to turn it into a night-life venue which comes with a high risk of public nuisance from drunk and disorderly patrons leaving the site late at night/early in the morning.</p> <p>This could also lead to increased traffic from taxis and cars at these late hours, increased littering, and potentially anti-social behaviour.</p> <p>There are many homes along Nuffield Road that will be affected by this, many of which contain new families and young children, as well as shift workers, commuters, and others who would be acutely affected by late night noise and the lack of sleep it would bring.</p> <p>When we bought our home we understood that we were moving to a residential area, albeit with some business premises that would operate reasonable hours. We do not want to be disturbed every weekend by late-night drinkers when the site is supposed to be a leisure centre.</p>
--	--	---

Reps in support of

Name	Date Received	Comments
[REDACTED]	21.03.2026	I fully support this - as a larger company and being a gym, I can't see that this would be an issue. [REDACTED], and think this being this close to our address is an amazing opportunity for us to go and relax after work and be able to have a drink or food without having to drive anywhere. It's what the development lacks at the moment. Although there are plans in place for a pub to be put over on loves farm, this won't be for several years. Having the gym with the extras it will have will support myself and my partner but also be a fun space for our children in the future. I hope that the older generation don't object to this through fear or it being too noisy - because in reality if the thought about it fully - that wouldn't be allowed. Fully support

This page is intentionally left blank